

NOTE: LANDING GEAR LENGTH SHOWN IN  
LIFT-OFF POSITION TO PROPERLY RETRACT IN SCALE  
POSITIONED WHEEL WELLS. FULL LOAD REST ATTITUDE  
WILL SHORTEN OLEO LENGTH BY 3/4"

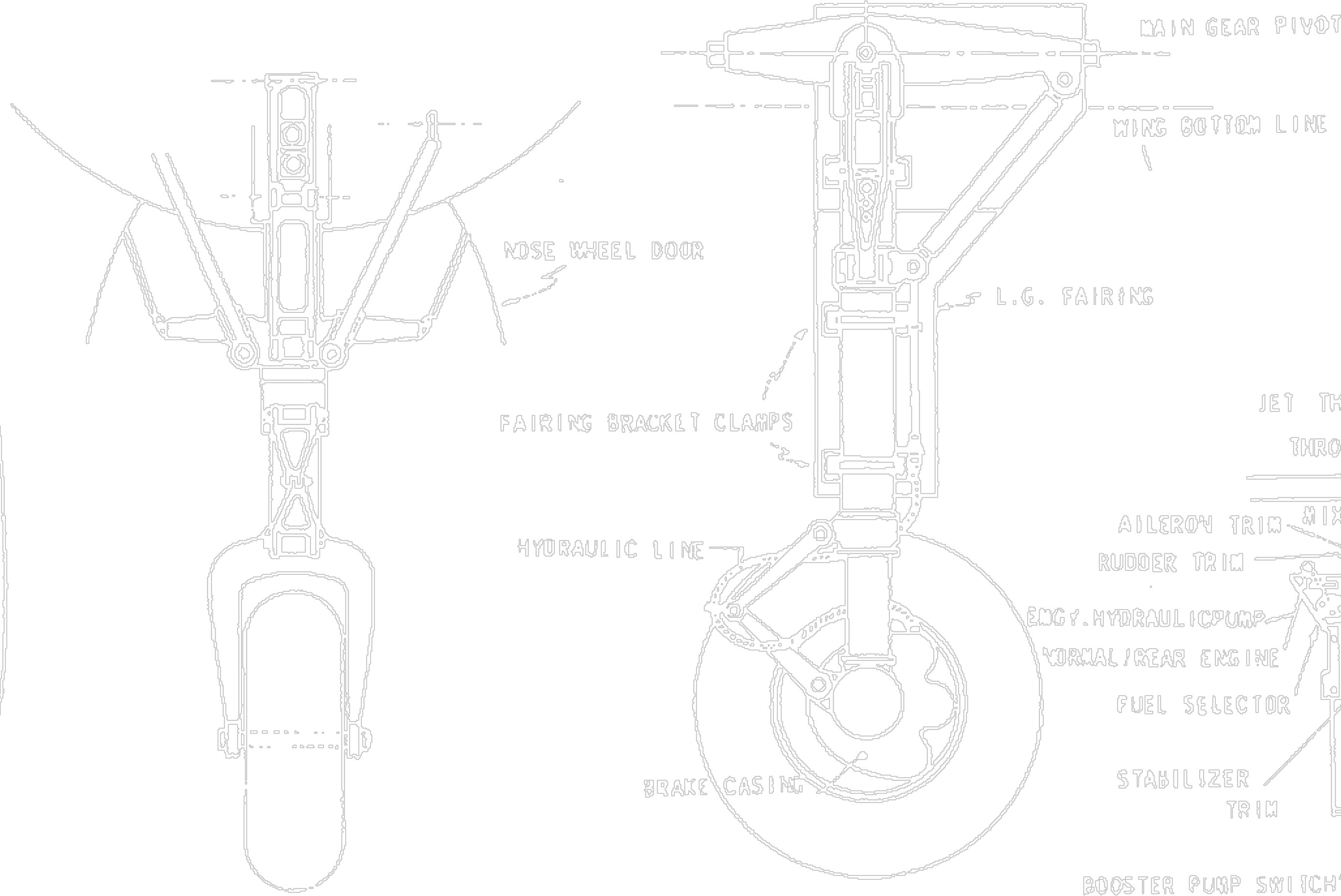

REAR VIEW OF  
NOSE GEAR

INSIDE VIEW OF MAIN LANDING GEAR

MAKE L.G. FROM 5/32" WIRE IF RETRACTABLE GEAR IS NOT USED. SET IN HARDWOOD  
GROOVED BLOCKS & NOTCH RIBS IN APPROPRIATE PLACES & EPOXY GROOVED STOCK  
IN CUT OUT NOTCHES.

- 1 ALTIMETER
- 2 AIR SPEED INDICAT
- 11 RAD/NAV HEADING
- 12 NAVIGATION CW
- 13 GUN SIGHT LAMP CONTROL
- 14 ARTIFICA
- 15 RPM
- 16 MANIFOLD PRESS.
- 17 CYL 1
- 18 ROCKET SELECTOR SWITCH
- 19 FUEL 1
- 20 ROCKETS ARMING TOGGLE SWITCH
- 21
- 22 PRIME
- 23 SPARE LAMPS
- 24 LAMP HOOD
- 25
- 26
- 27
- 28
- 29
- 30
- 31
- 32
- 33
- 34
- 35
- 36
- 37
- 38
- 39
- 40
- 41
- 42
- 43
- 44
- 45
- 46
- 47
- 48
- 49
- 50
- 51
- 52
- 53
- 54
- 55
- 56
- 57
- 58
- 59
- 60
- 61
- 62
- 63
- 64
- 65
- 66
- 67
- 68
- 69
- 70
- 71
- 72
- 73
- 74
- 75
- 76
- 77
- 78
- 79
- 80
- 81
- 82
- 83
- 84
- 85
- 86
- 87
- 88
- 89
- 90
- 91
- 92
- 93
- 94
- 95
- 96
- 97
- 98
- 99
- 100

32 HYDRAULIC PRESS. GUAGE

